



12 oz. Popcorn Machine Instruction Manual

SSX19P107KO (Black) / SSX19P110KO (Red)

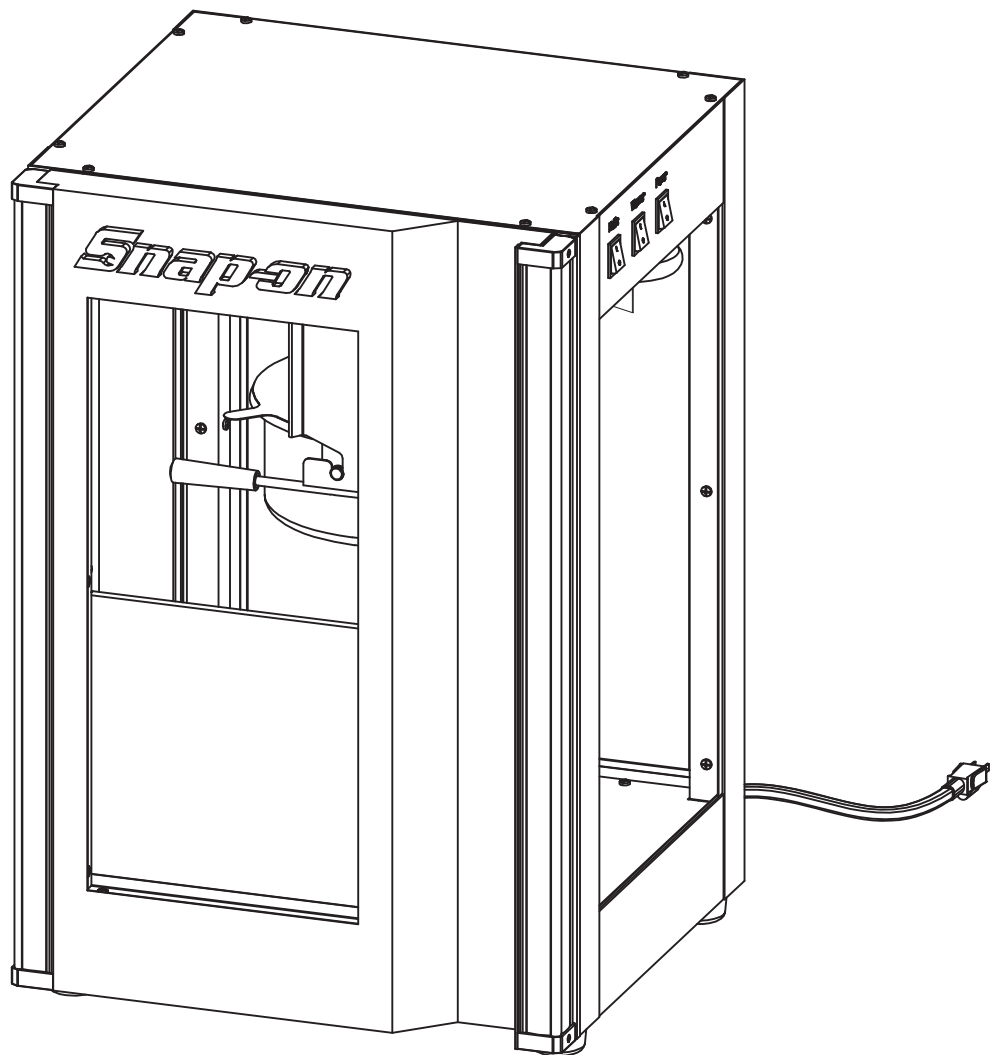

TABLE OF CONTENTS

WARRANTY	3
FUNCTION AND FEATURES	4
SAFETY MESSAGES	4
IMPORTANT SAFEGUARDS	5
OPERATING PROCEDURES	5
BEST POPCORN TO OIL RATIO	6
CARE AND MAINTENANCE	7
SPECIFICATIONS	7
TROUBLESHOOTING GUIDE	8

Dear Customer,

Before operating your new Popcorn Machine, please read the Instruction Manual carefully. It contains important information for safe installation, use and care of the appliance. Be sure to keep this manual for future reference.

Notes which are important for your safety, or for the proper functioning of the unit, are indicated with a warning triangle and/or with signal words (Warning!, Caution!, Important!). Please observe the following symbols carefully.

⚠ CAUTION

⚠ WARNING

To assist you in operation, the manual provides helpful instructions for correcting common problems in the “Trouble Shooting” section on page 7.

WARRANTY

Thank you for purchasing the Snap-on® **SSX19P107KO/SSX19P110KO 12 oz. Popcorn Machine**. Your **SSX19P107KO/SSX19P110KO 12 oz. Popcorn Machine** is guaranteed against defects in material and workmanship for the period of one year (1 – Year) from the date of purchase. This warranty is limited to the original purchaser of product. Product found to be defective during that period will be repaired or replaced by 4J International Inc. at no charge. Warranty does not cover any shipping damage. This warranty is void if it's determined that unauthorized parties have attempted repairs or alterations of any nature. 4J International Inc. disclaims any liability for other incurred damages resulting from product defects. Any expenses in the removal and re-installation of products are not covered by this warranty.

4J International's total liability will not exceed the purchase price of the product. A Return Goods Authorization number (RGA) is required before shipping product back to 4J international Inc.

Please call 1-262-656-1956 to obtain an RGA number.

Snap-on is trademark of Snap-on Incorporated and used under license.

© Snap-on Incorporated 2019. Designed and Engineered in USA. Made in China.

© 2019 4J International Inc. All rights reserved.

4J INTERNATIONAL INC. 7001 – 30th Avenue Kenosha, WI 53142 USA
Tel:1-262-656-1956

FUNCTION AND FEATURES

The Snap-on® **SSX19P107KO & SSX19P110KO Popcorn Machine** is made of stainless steel and designed with durable glass and powder coated metal. Easy to operate and energy efficient, the machine is designed for home and shop use.

SAFETY MESSAGES

These warnings are provided for your safety. Please read this manual to ensure that you fully understand all warnings and cautions before installing or operating the unit. Your safety is important. If you are unsure about the meaning of these warnings, contact 4J International Customer Service at 262-656-1956, or email Customerservice@4J-Intl.com for assistance.

Intended use

- The Popcorn Machine is intended for use in the home or shop.

Prior to initial start-up

- Check the unit for transport damage. Under no circumstances should a damaged unit be plugged in.
- In the event of damage, please contact 4J International at 262-656-1956, or email Customerservice@4J-Intl.com for assistance.

⚠ CAUTION

- **The machine should always be set up flat and on stable ground.**
- **The machine must be used with a suitable power source. Factory suggestion : 110V.**
- **Suitable outlets and fuse box are recommended for proper installation of the machine.**
- **The power source outlet should include a safe, three-pin plug in the outlet.**
- **All electrical connections must be done by a qualified electrician.**

⚠ WARNING

- **Keep all ventilation openings in the appliance enclosure or built-in structure, clear of obstruction.**
- **The cord should not be folded or rolled into a coil during operation.**
- **Do not use an extension cord with this appliance.**
- **Disposal of the appliance must be at an authorized waste disposal center.**
- **Before obtaining access to electrical terminals, all supply circuits must be disconnected.**
- **If the SUPPLY CORD is damaged, it must be replaced by the manufacturer, its service agent or similarly qualified person in order to avoid a hazard.**

In Case of Malfunction

- If a malfunction occurs with the unit, please reference the Trouble Shooting section on page 5. If the provided information does not resolve the problem, do not perform any further repairs yourself. Please contact 4J International at 262-656-1956, or email Customerservice@4J-Intl.com for assistance.
- Under no circumstances should you attempt to repair the unit yourself. Repairs carried out by an unqualified person may cause serious injury or malfunction, and will void the warranty.

Important Safeguards

When using electrical appliances, basic safety precautions should always be followed including the following:

READ ALL INSTRUCTIONS BEFORE USING YOUR POPCORN MACHINE.

- Do not touch hot surfaces. Always use handles or knobs to operate.
- To avoid any risk of electrical shock, do not immerse cord or plug in water.
- Close supervision is necessary when operating machine near children.
- Unplug main power cord from outlet while not in use and before cleaning.
- Allow hot parts to cool down before moving or cleaning.
- Using any accessories or attachments not provided or recommended by the manufacturer may result in injury.
- Do not pop kernels in a dry kettle (without oil).
- Do not immerse the kettle in water.
- Kettle surfaces are HOT and should NOT be touched during the popping process or immediately after use.
- Unplug, clean and cover the unit while not in use. Store in a dry, safe place.
- Do not leave the power cord hanging over edge of table or counter, or allow it to touch hot surfaces.
- DO NOT place the unit on or near a hot gas or electric burner, or in a heated oven.
- Turn ALL switches to "OFF" position before disconnecting power plug from the outlet.
- Extreme caution must be used when unloading popcorn. Always use oven mitts!

OPERATING PROCEDURES

Please Note: If you are using your popper for the first time, clean the interior of the glass surfaces and wipe the inside of your popper with a clean damp sponge before heat is applied. Please follow these procedures for the best operating results and long machine life.

Operation

- Place the corn popper on a dry, level surface. Protect from rain and other weather elements. Do not install near pool or water.
- Plug the unit into a suitable grounded electrical outlet. (Please check the electrical specs. Be sure that your power source matches the rating label specified next to the power cord).
- Open door and drop chute down. Hook kettle to main unit by sliding pins into side notches while aligning rod with gear assembly. (Note: Push rod back until it snaps into place. Gears must be aligned to ensure proper meshing.) Roller ball should be positioned on door side.
- Locate interior plug outlet on top-right panel. Flip open cover and plug three-pin plug into outlet.
- Push chute back up. Firmly close door.
- The Main unit has 3 function switches: Kettle (Kettle Spin), Warmer (Kettle Heat) and Power (Light/Warmer).

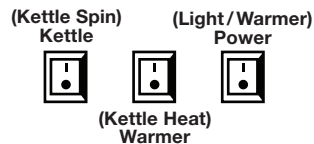

- Turn on the Power (Light/Warmer) Switch to activate the bottom panel warmer and light.
- Turn on the Warmer (Kettle Heat) to preheat the kettle for approximately 3-4 minutes. And also turn on the Kettle (Kettle Spin) Switch to rotate the kettle arms. Pour ½ cup oil and 1½ cups corn into the kettle.

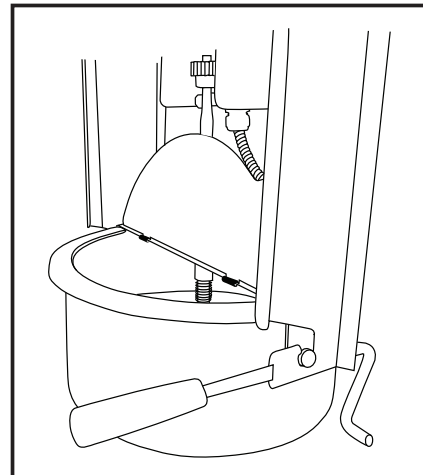

- Close the door firmly.
- The corn will begin to pop as it stirs inside the kettle. Always pay close attention to the corn while popping. Stop the machine (turn off the kettle switch) if you see any signs of burning. Allow the corn to stir and pop, until all popping is completed, before rotating the kettle. (Note: To avoid popcorn sometimes getting stuck or clumping inside the kettle, midway through popping cycle open the door and lift the left kettle lid door open by the lift tab. Remember to again close the main door until popcorn popping is complete.)
- Turn off the Kettle (Kettle Spin) and Warmer (Kettle Heat) Switches.
- Firmly grasp black handle and rotate kettle downward 90 degrees to remove all of the popcorn from the kettle. **Caution: Kettle is hot make sure to use the handle.** Salt or season popcorn as desired.
- Repeat the above steps to make more popcorn. It takes approximately two minutes of continuous popping to complete the process.
- Turn off Power (Light/Warmer) when popcorn is completely served or leaving the machine unattended.

BEST POPCORN TO OIL RATIO

Size of Machine	Amount of Oil	Amount of Corn
4 oz.	¼ cup	½ cup
6 oz.	¼ cup	¾ cup
8 oz.	⅓ cup	1 cup
12 oz.	½ cup	1½ cup

Bulk Corn and Oil Measurements

Use the chart below to get the right measurement of corn and oil.



All-in-one popcorn packs are also available. These pre-measured popcorn packets include all of the necessary ingredients for making great popcorn, easy to use and conveniently portioned. They include the kernels, oil, and salt flavoring.

Do not drop any oil around the plate! There's a risk it will catch on fire when reaching a certain temperature.

⚠ WARNING

DO NOT ADD ANY WATER TO THE PLATE WHILE MACHINE IS POPPING.

⚠ CAUTION

Hot kettle! Handle with oven mitts. Keep children at a safe distance from popper during operation.

⚠ CAUTION

- **After popping cycle is complete, the popping kettle will be very hot. Use extreme care when handling.**
- **Remember to turn the kettle switch to the OFF position after the popping cycle is completed.**
- **Unplug unit BEFORE removing kettle from hanger. Use caution not to bump heat lamp bulb during removal.**

CARE AND MAINTENANCE

The Popcorn Machine should be cleaned and maintained at least every two months. For hygienic reasons, the machine's interior – including all interior accessories – should be cleaned regularly. Unplug the unit, remove the food and storage basket.

⚠ WARNING

The appliance must be unplugged during cleaning. Before cleaning, switch the appliance off and remove the plug from the main outlet, or turn off the circuit breaker/fuse. Never clean the machine with a steam cleaner. Moisture could accumulate in the electrical components, resulting in the danger of electrical shock! The machine should be dry before it is placed back into service.

Before cleaning the machine, turn off the power and remove the plug from the electrical outlet. You can use a wet towel with anticorrosive detergent to clean the external parts of the machine. Do not clean the machine directly with water; the electric functions could be damaged. Do not brush the interior plate with metal. Doing so, will damage the coat. Keep the unit unplugged if the machine is not being used regularly.

SPECIFICATIONS

Item NO	SSX19P107KO/SSX19P110KO
Power (V)	110 AC
Output (kW)	423 kW
Frequency (Hz)	60 Hz
Temperature	122 °F–482 °F (50~250 °C)
Dimensions	20" W x 18.25" D x 30" H
Oil Dosage	½ cup
Corn Dosage	1½ cups
Kettle Size	12 oz.

TROUBLESHOOTING GUIDE

You may be able to rectify a malfunction yourself by using the following instructions. Do not perform any other work on the machine if the following information does not remedy your problem.

IMPORTANT!

Repairs to Popcorn Machines may only be performed by competent service engineers. Under no circumstances should you attempt to repair the machine yourself. Repairs carried out by an unqualified person may cause a serious injury or malfunction.

Problem	Possible Cause	Possible Remedies
Light is not on.	1. Not plugged into outlet.	1. Plug into outlet.
Will not heat.	1. Loose wire in the heating tube. 2. Burned out heating tube. 3. Broken electric capacity.	1. Fasten the screw from which the wires exit. 2. Replace the heating tube.
Temperature: too high or too low.	1. Broken thermostat.	1. Replace the thermostat.

Disposal of the appliance

- It is prohibited to dispose of this appliance in domestic household waste.
- Contact your local municipality for the established waste disposal site in your area.



Note: This marking indicates that this product should not be disposed with other household wastes. To prevent possible harm to the environment or human health from uncontrolled waste disposal, recycle it responsibly to promote the sustainable reuse of material resources.